

# BUILD YOUR OWN HINGE KIT

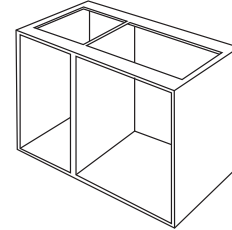

## FULL OVERLAY FOR EURO STYLE CABINETS

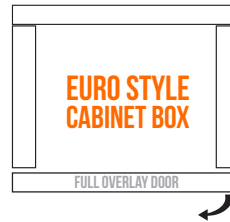

FRAMELESS (EURO STYLE)

- Heavy Duty Hinge Cup-to-Arm Connection
- 6 Laminated Steel Linkage Connectors

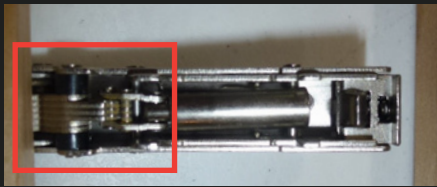

- Depth & Side to Side Cam Adjustments
- Height Adjustment in Base Plate
- Easy Clip-On of Hinge-to-Baseplate Options
- 45mm c/c Hinge Cup Screw Spread
- Competitive Pricing to Lower Door Hardware Costs
- Limited Lifetime Warranty

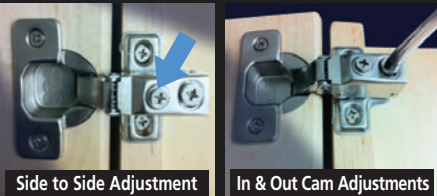

Call us or visit us in store today for more info on our **Inset, Full Overlay, & Face Frame Style** Cabinet Hardware.



909.357.7730

### 1 PICK YOUR HINGE

#### SOFT CLOSE

8mm Dowels  
110 Degree Clip  
4-Way Adjustable  
Soft Close Hinge

**2431016**  
Box / 250 Qty



Screw On  
110 Degree Clip  
4-Way Adjustable  
Soft Close Hinge

**2431019**  
Box / 250 Qty



#### SELF CLOSE

8mm Dowels  
110 Degree Clip  
Soft Close Hinge

**2431041**  
Box / 250 Qty



Screw On  
110 Degree Clip  
Soft Close Hinge

**2431042**  
Box / 250 Qty



### 2 PICK YOUR PLATE

#### ADJUSTABLE

0mm Zinc  
Height Adjustable  
Euro Style  
Mounting Plate  
w/o screws

**2432023**  
Box / 250 Qty



#### STANDARD

0mm Steel  
Euro Style  
Mounting Plate  
w/o Screws

**2432017**  
Box / 250 Qty



\* Full Overlay Based  
5mm Tab Distance



TAB DISTANCE	
MM	3 4 5 6 7
PLATE HEIGHT	0 14 15 16 17 18
2	12 13 14 15 16

GIVES YOUR DOOR OVERLAY

### 3

#### DON'T FORGET FASTENERS

#### #6 PHILLIPS SCREWS



1/2" FLAT HEAD  
COURSE THREAD  
ZINC SCREW

**MAX612PHILFLT**  
Bag / 1K Qty

5/8" FLAT HEAD  
COURSE THREAD  
ZINC SCREW

**MAX658PHILFLT**  
Bag / 1K Qty

3/4" FLAT HEAD  
COURSE THREAD  
ZINC SCREW

**MAX634PHILFLT**  
Bag / 1K Qty

### 5/8" STANDARD FOR OVERLAY

Conversion Chart	inches	.031	.063	.094	.125	.156	.188	.25	.281	.313	.344	.375	.406	.438	.469	.5	.563	.594	<b>625</b>	.656	.719	.75	.781	.844	.875	.906	.938	1
	mm	1	1.5	2	3	4	5	6	7	8	9	9.5	10	11	12	13	14	15	<b>16</b>	17	18	19	20	21	22	23	24	25.4
		1/32	1/16	3/32	1/8	5/32	3/16	1/4	9/32	5/16	11/32	3/8	13/32	7/16	15/32	1/2	9/16	19/32	5/8	21/32	23/32	3/4	25/32	27/32	7/8	29/32	15/16	1