

# INDAUX

ARIANE S drawer

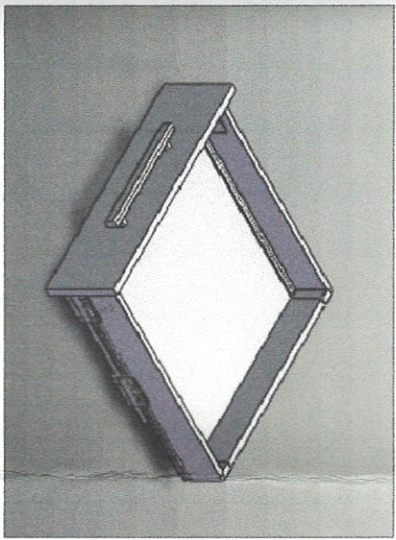

### Special Features:

- Length: 300, 350, 400, 450, 500, 550mm.
- The drawer side-board is 88mm high.
- Drawer width can be designed freely with automatic error adjustment.
- Hidden full pullout silencing sliding sld can bear 30kg and enjoys excellent stability and quite and smooth sliding performance.
- Quick installation and dismantle.
- Newly-designed built-in damper is free from reinstallation and ensures soft and smooth drawer movements.

Back length	Internally usable drawer depth	Minimum installation depth of drawer	Minimum installation height
300mm	274mm	300mm	110mm
350mm	324mm	350mm	110mm
400mm	374mm	400mm	110mm
450mm	424mm	450mm	110mm
500mm	474mm	500mm	110mm
550mm	524mm	550mm	110mm

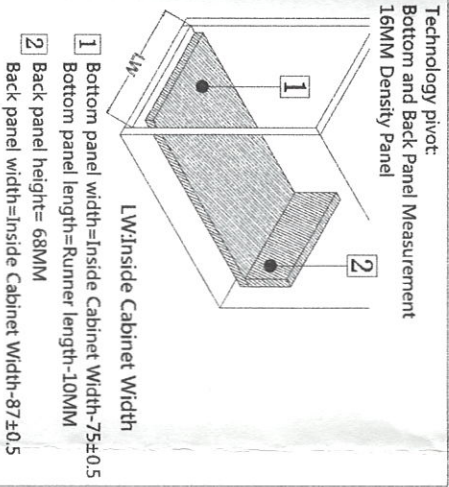
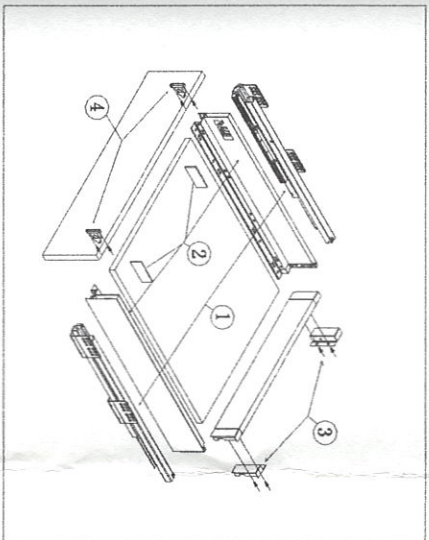

### Runner Installation(mm)

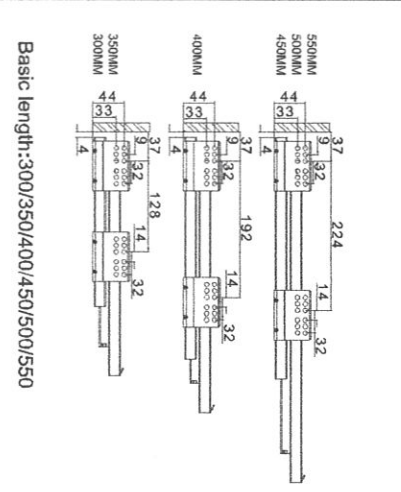

### INDAmatic

#### Inside Cabinet Dimension

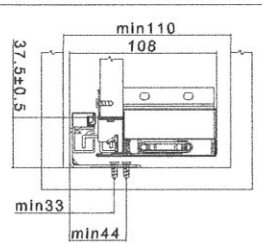

#### Front Panel Mounting Positions

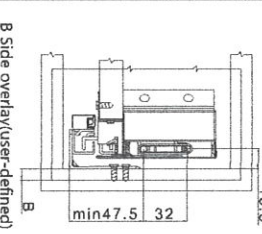

#### Front Fixing Brackets Positions

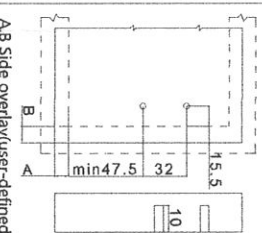

#### Back Panel Mounting Positions

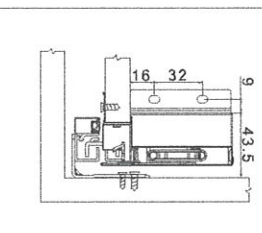

#### Front fixing brackets mounting

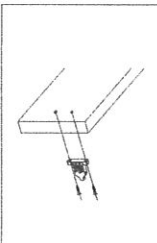

#### B Side overlay(user-defined)

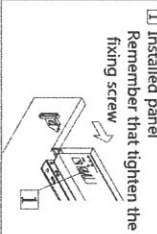

#### Front panel removing

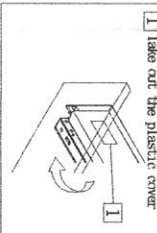

#### Loosen the fastening screws

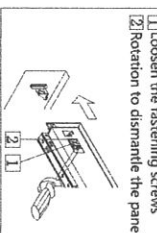

#### Front panel height adjustment : ±2mm



#### Front panel side adjustment : right/mm

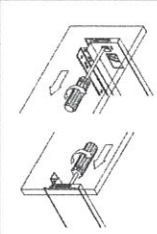

#### Front panel side adjustment : left/mm

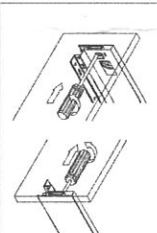

#### Mounting the drawer

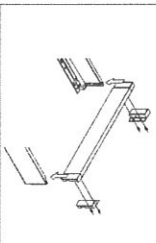

#### Function of the damper

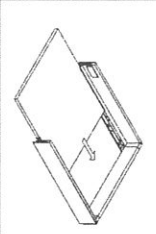

#### Installing the drawer

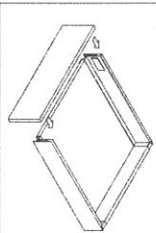

#### Removing the drawer

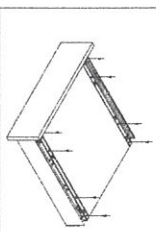

#### Function of the damper

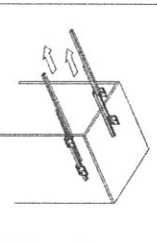

#### Installing the drawer

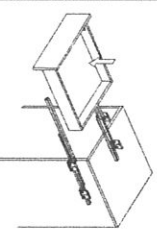

#### Removing the drawer

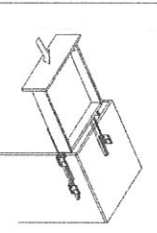

#### Function of the damper

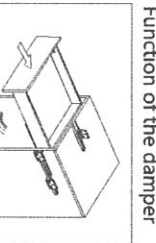

#### Installing the drawer

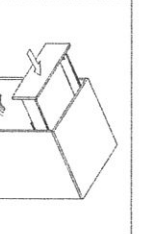

#### Removing the drawer

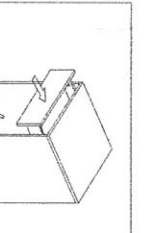

#### Function of the damper

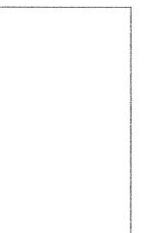

Push the metal spring part from the panel & pull out