



# BUSSOLOTTI

BY  **SALT**  
INTERNATIONAL



# WHAT IS BUSSOLOTTI?

## PREMIUM COMPONENTS THAT ARE A PLEASURE TO BUILD

This system offers more than your standard Ready to Assemble (RTA) cabinets. Our Integrated System sets you up for success by offering premium components as a full system designed to work together, down to the screws. Parts go together easily the first time. Bussolotti is redefining box systems by including; industry-leading hardware, water-resistant interiors, time-saving box leveling solutions, and on-trend and in-demand prefinished door options.

Be able to offer your customers a premium product on their schedule. Don't turn down projects because of a long backlog, short staff, or downed machinery. Bussolotti's simple box assembly makes you more efficient while Peterman Lumber's color choices make it feel like a truly custom system. Peterman Lumber is able to custom make doors to your specification in any of our 175+ prefinished options. Expect commercial-grade durability that is equal to the stunning colors and textures you can choose from.

- Components made from premium linen-textured, 13-hour water-resistant panels.
- Over 175+ premium made to order cabinet doors, available in modern styles.
  - Textured Woodgrain
  - High Gloss
  - Super Matte
  - Acrylic Back Painted Glass & Frosted Glass
  - Metal
  - Concrete
- Includes premium industry-leading box hardware for Euro-style boxes
  - Salice Silentia+ Soft Close Hinges.
  - Blum Tandembox System with Blumotion Soft Close Under Mount Slides.
- Convenient Leveling and Integrated Toe Kicks.
- Options for Handle free solutions.
  - Gola Integrated Handle System
  - Filo & Karmen Fingerpulls
- Storage solutions like trash Pullouts, Lazy Susans, and Roll Out Shelves.
- Peterman Lumber believes in the reliability and precision of the Bussolotti system and warrants the material and craftsmanship of the components to be defect free and fit together precisely or we will give you a replacement.







# HYDRO BOX

## 13 HOURS OF WATER RESISTANCE

Water is apart of day to day life. You should have a box system that accounts for that. Our Hydrocore is engineered to stand up to daily abuse because accidents and spills happen. Long showers, and steam from daily cooking can cause severe warping from moisture working its way into the core material. Our Hydrobox solves that problem with 13 hours of water resistance built into the core. Our Hydrocore will not warp like typical plywood components found in your run of the mill RTA cabinets, because of the formulation of our resin fused core that repels water. Bussolotti goes a step further to provide a PUR edgebanding that creates a waterproof glue line with an ABS (Plastic) edgebanding to create an exterior barrier that not only protects your investment and gives you peace of mind that you will not have to replace components due to a common sink leak.

Salt International has done 13 hour comparison studies on Saviola Hydrocore vs the leading composite panels used in RTA cabinets. Cross cut unbanded samples are submerged in water for a 13 hour period. Consistently the composite panel samples swell and delaminate before the 13 hour mark. The Hydrocore is removed with no change to the thickness of the board or raised surface. Saviola produces the only ecological panel on the market that saves discarded furniture from the landfill and uses a non chemical separation process that has zero impact on the environment. Feel great knowing that your boxes are protected from moisture and that your purchase is helping to protect the environment.



### LEARN MORE

Scan this QR code to learn more about Saviola's Ecological process.



## 13 HOURS OF WATER RESISTANCE



STANDARD COMPOSITE PANEL



SAVIOLA HYDROCORE



# MELAMINE VS. PLYWOOD

Not all materials are made the same or have the same specifications. There are materials recommended for specific applications that make life just a little bit easier. Screws have better holding ability than nails – even though both are fasteners.

Efficiency and reliability are the guiding principles behind Bussolotti and the main reason we prefer to use melamine versus plywood for our cabinet boxes. Bussolotti's Hydrocore is a highly stable melamine panel that is made up of a hardwood particulate core. Hardwood composite panels are known for their durability and superior screw holding. Our Hydrocore is fused together with resin that repels moisture, where plywood uses water based adhesives. While water based adhesives are great for the environment they are guaranteed to warp as soon as they come in contact with moisture.

Did Europeans design melamine boards with the intention of making a perfectly sequenced pattern across their cabinet doors – or did that trend come out of a benefit they saw in how the product is made? The beauty of Italian design is in the connections between function and aesthetics. Because of the manufacturing process, the pattern and color is consistent board to board so you are able to offer trends like grain matching. It also eliminates unpleasing elements like knots, mineral streaks, and color differences naturally found in plywood. It also makes it easy to replace doors over time because of the colorfastness that doesn't fade over time.







# CNC PRECISION

Bussolotti uses Italian design that has efficiency at the heart of the system. Components take minutes to assemble and fit together precisely. Human error is eliminated by CNC routing so all cuts are consistently where they should be. Giving you quick and effortless installation that only requires a rubber mallet, drill, and a weatherproof adhesive. We measured twice so you can rest assured that everything will perfectly align every time.

- Predrilled Holes Require No Measuring
- Tops, Bottoms, and Rails include Pre-inserted Hardwood Dowels
- Hinge Cup Holes for Concealed Hinges
- Predrilled for Level Full-Depth Adjustable Shelving
- Gabels Predrilled for Blum Tandembox System
- Dado Inset for Added Strength
- Predrilled for Leg Leveling Kit

Perfectly routed parts do not do much if they are not good materials to start with. Bussolotti researched the best materials that work together for cabinetry applications. The Hydrobox has an inset dado that gives strength to horizontal panels while keeping a square and level box. Hardwood dowels and confirmat screws were made specifically to be used with composite cores for their durability. We recommend TitebondII Weatherproof adhesive in all dado and dowel holes to keep tight joints and extra water resistance in routed areas.



# PREMIUM HARDWARE

## STYLE EQUAL TO RELIABILITY

Salt International has sourced industry leading hardware from Salice and Blum that comes included standard with our system. Our Mahnolia Linen components compliment Blum's Tandembox giving a crisp clean look that accentuates any style from modern to transitional.

## BLUM TANDEMBOX DELUXE METAL DRAWER WITH BLUMOTION SOFT CLOSE UNDERMOUNT SLIDES

Quality and style that lasts. These tried and tested drawers open smoothly and gently, even fully loaded. Drawers close softly with Blum's undermount slides with integrated soft close technology. Easy adjustment with just a few turns. One of the many benefits of this system is the three dimensional adjustment mechanism that allows you to adjust height, tilt and side adjustment of the box.

## SALICE SILENTIA + SOFT CLOSE HINGES

State of the art in soft close technology. From the inventors of the soft close hinge, you can expect premium performance and more from Salice. Soft close hinges slow down doors to prevent from slamming shut while our Silentia+ series is equipped with an innovative switch that allows your door to quickly close to the last 10 degrees before it slows down. Giving you control of how fast (or slow) your doors close. Leaders in innovation and engineering Salice has replaced traditional two way adjustment with one simple turn. Spend less time with adjustments and still get a tight door gap with a perfect close.

LEARN MORE

Scan the QR code to learn more about Blum Tandembox.



LEARN MORE

Scan the QR code to learn more about Salice.





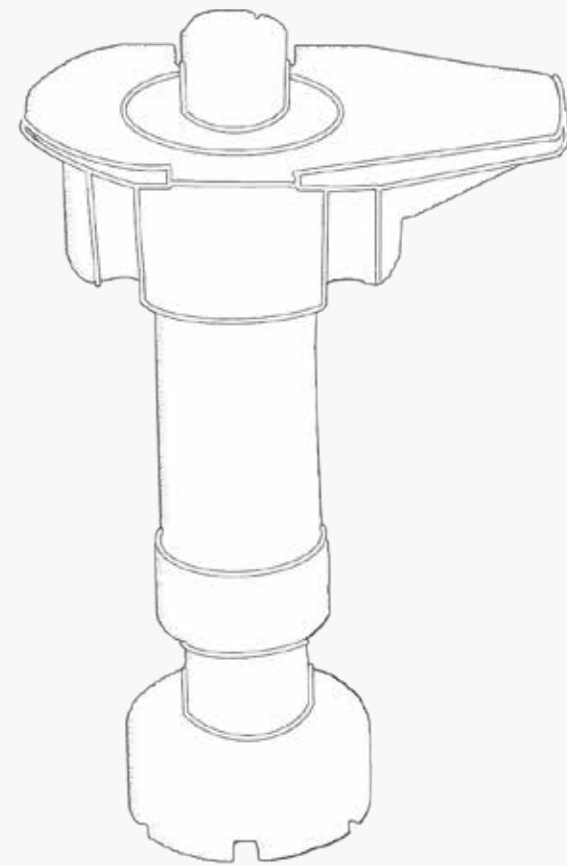

LEG110 + PUCK

## PVC LEG LEVELERS

These PVC leg levelers have an extended lip on the socket that shifts the weight to the stronger vertical panel to prevent blowouts from uneven weight on the bottom of the cabinet. Available in three different heights with a total adjustability of 1.25". Providing you with an easy solution for quick and toolless adjustment.

# PVC LEVELING KIT

Find the beauty of efficiency. Salt International has curated the best components to configure everything that is needed to install a fully functioning cabinet box in one complete system. We even came up with solutions for components you are not meant to see, like the leveling kit. This lightweight PVC system is lightweight and naturally warp resistant. And can be installed without any shims, screws or nails. Making sure even the smallest details cleanly installed.

## TOEKICK OPTIONS

Bussolotti stocks matching Metal foil covered PVC toekicks to our Gola Finishes, and has capabilities to fabricate any of our 175+ color options in either grain direction. Our integrated toekicks easily clip onto our leg levelers to quickly cover up or access your box levelers.

- \* 4 PVC Leg Levelers come per base cabinet.
- \*\* Leg clips not included in price.
- \*\*\* Dowel works with PVC Toekicks and Screw in work with matching panel toekicks.

## AVAILABLE FINISHES

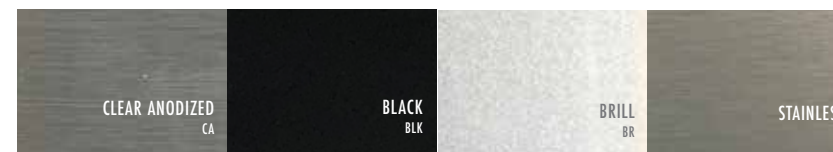

## ACCESSORIES



LEG CLIP

DOWEL : TKDCLIP  
SCREW : TKSCLIP



TOEKICK 90  
CONNECTOR  
SI (FINISH) VDC120



TOEKICK  
CONNECTOR  
SI (FINISH) 90D120



TOEKICK FLEX  
CONNECTOR  
SI (FINISH) 90D120



# FLAT PACKED

Our #1 priority is to deliver your components in the best condition. When pulling components we carefully inspect each piece before taking to our packing area. Parts will come expertly packed, shrink wrapped on a pallet with like parts together. We will do our best to get component parts as close as possible while keeping a stable palletized unit that prevents damage during delivery.

Your Pallet will be delivered on Peterman Lumber trucks by the same friendly drivers that have been delivering material throughout the Southwest. Peterman Lumber is an expert in handling high grade materials, and delivering them with care to your fabrication shop, or job site. Talk to your sales representative about our LTL shipment capabilities.





# GOLA HANDLE-FREE SYSTEM



## SIMPLE. CLEAN. EFFICIENT.

Designed to be a clean solution for a large bank of doors or drawers. The Gola system is routed to fit in flush to your cabinet box. Leaving an exposed decorative metal extrusion to eliminate the need for individual knob or pull hardware on each door.

This is our most efficient and low profile hardware system. Salt International pre-routes and drills cabinet boxes for all these profiles to make installation simple. Just select the color of the exposed channel and components will be packaged as a kit and ready to go. Our Gola system is a perfect match to our metal Toekick color options.

All of our extrusions are also available as LED lighted options.

## AVAILABLE FINISHES

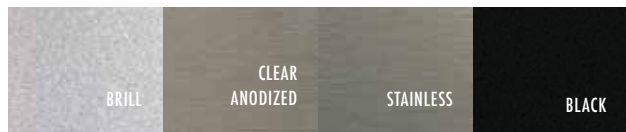

## UPPER DRAWER

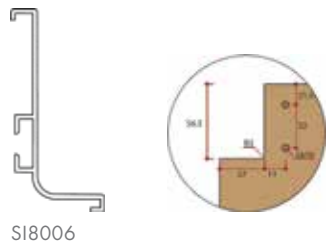

SUPPORT & H CLIP  
DOWEL: SIGFXKIT  
SCREW: SIGFXKITSREW



END CAP  
SICEC8006



EXTERIOR CORNER  
SIEC8006



INTERIOR CORNER  
SIIC8006

## LOWER DRAWER

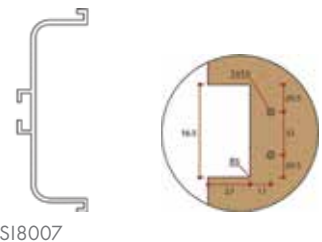

SUPPORT & H CLIP  
DOWEL: SIGFXKIT  
SCREW: SIGFXKITSREW



END CAP  
SICEC8007



EXTERIOR CORNER  
SIEC8007



INTERIOR CORNER  
SIIC8007

VERTICAL TALL PANTRY



## VERTICAL TALL PANTRY

### SINGLE VERTICAL

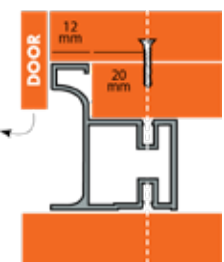
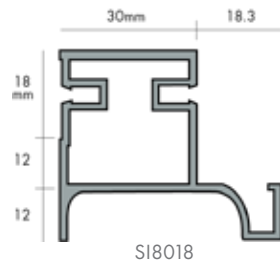

### DOUBLE VERTICAL

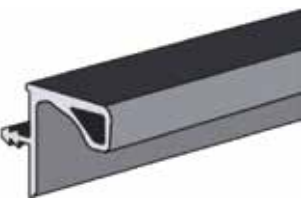
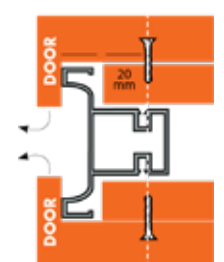
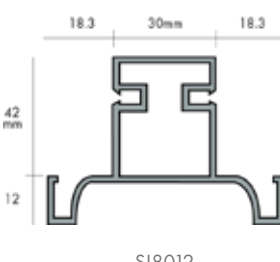

## UPPER CABINET

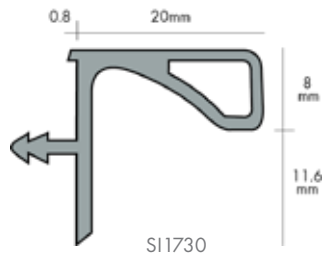
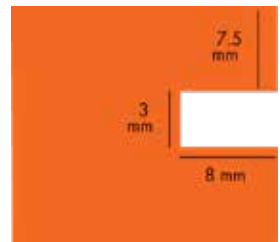





# FILO & KARMEN

## FINGER PULL SYSTEM

Same sleek look as our Gola system - but used as finger pull application where the installation is on the doors instead of the cabinet box.

Filo & Karmen extrusions give a nice metal grip on the top of your doors or drawers. These two profiles can be used exclusively, but if used together give a beautiful recessed metal separation between drawers. A much faster and economical alternative to install on large banks of doors and drawers than traditional pulls.

## INSTALLATION

Simply route one edge of your doors and screw on the extrusion. Filo and Karmen are two separate profiles but the application is the same. Filo Profile is most commonly used as the upper, and Karmen as the lower. This system is available as extrusion only and is not available pre-routed on your doors.

Filo & Karmen come in 9ft lengths.

### KARMEN SIKARMEN27

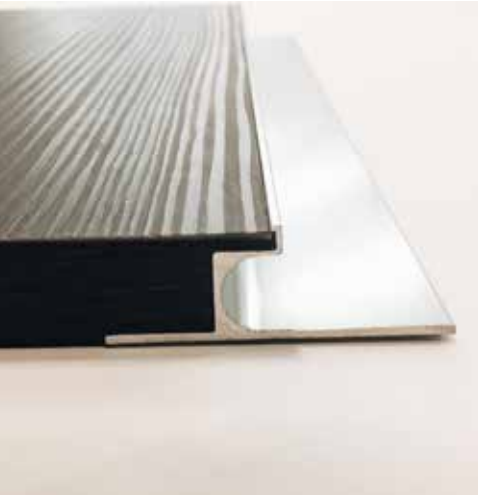
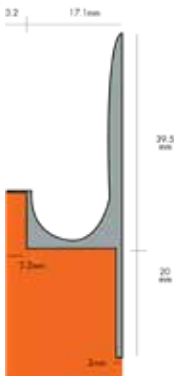

### FILO SIFILO27

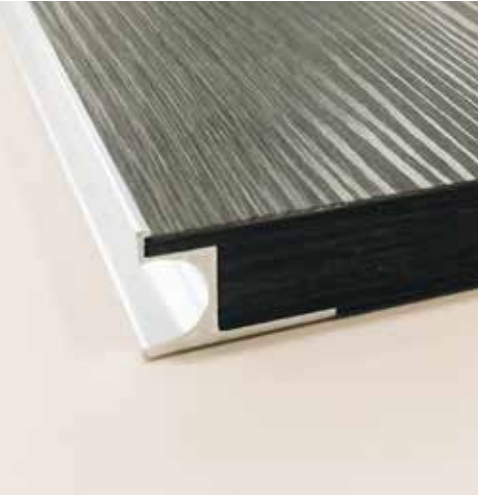
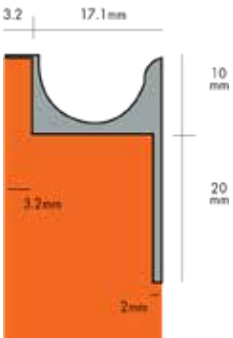





# LOLA SCALABLE PULLS

HANDLES THAT WIDEN WITH  
THE OVERALL LENGTH OF THE DRAWER

Our Lola Drawer Pulls are designed to be cut to the size of your drawer. What makes these drawer pulls so unique is that the teardrop handle scales to be wider as the overall length of the drawer increases, so you have a handle that never looks too large or too small. Lola gives a decorative touch that is subtle, but will not go unnoticed.

Available in lengths from 12" - 48" and can be used in a vertical or Horizontal application. Lola can be screwed on directly to the door, with an optional 2mm rabbet for flush mounting. Lola is available as extrusion only and is not available pre-routed on your doors.



## HANDLE WIDTH WIDENS WITH OVERALL LENGTH

HANDLE SIZE	TOTAL LENGTH	CODE
30.875"	47.875"	SILOLA.1216
27.875"	41.875"	SILOLA.1163
24.875"	38.875"	SILOLA.987
24.875"	35.875"	SILOLA.911
20.875"	32.875"	SILOLA.835
20.875"	29.875"	SILOLA.759
13.875"	23.875"	SILOLA.606
12.5"	20.875"	SILOLA.530
11.875"	17.875"	SILOLA.454
10.875"	16.875"	SILOLA.416
7.875"	14.875"	SILOLA.378
7.875"	13.875"	SILOLA.340
7.875"	11.875"	SILOLA.301

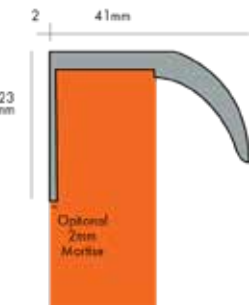
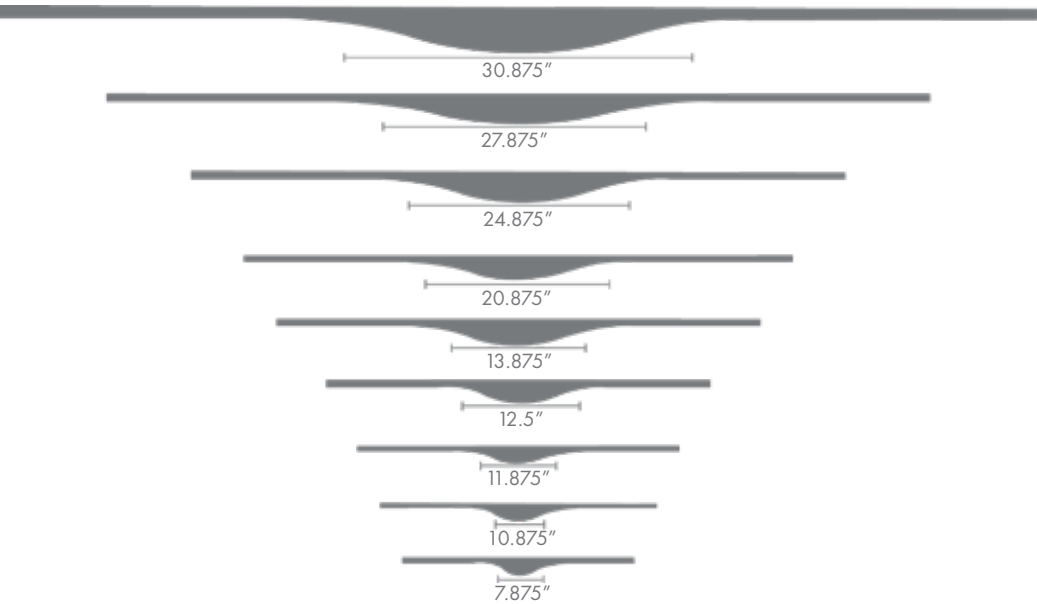

## FINISHES





# WALL CABINETS

## ONE DOOR

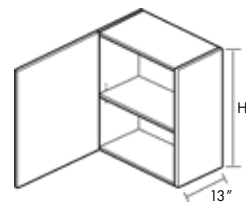

standard depth of 13"

30" HIGH INCLUDES 2 SHELVES  
09" WIDE : W0930  
12" WIDE : W1230  
15" WIDE : W1530  
18" WIDE : W1830  
21" WIDE : W2130  
24" WIDE : W2430

36" HIGH INCLUDES 2 SHELVES  
09" WIDE : W0936  
12" WIDE : W1236  
15" WIDE : W1536  
18" WIDE : W1836  
21" WIDE : W2136  
24" WIDE : W2436

42" HIGH INCLUDES 3 SHELVES  
09" WIDE : W0942  
12" WIDE : W1242  
15" WIDE : W1542  
18" WIDE : W1842  
21" WIDE : W2142  
24" WIDE : W2442

## TWO DOOR

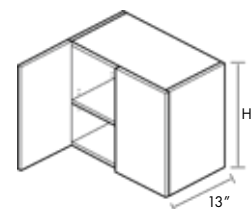

standard depth of 13"

30" HIGH INCLUDES 2 SHELVES  
24" WIDE : W2430-2  
27" WIDE : W2730  
30" WIDE : W3030  
33" WIDE : W3330  
36" WIDE : W3630

36" HIGH INCLUDES 2 SHELVES  
24" WIDE : W2436-2  
27" WIDE : W2736  
30" WIDE : W3036  
33" WIDE : W3336  
36" WIDE : W3636

42" HIGH INCLUDES 3 SHELVES  
24" WIDE : W2442-2  
27" WIDE : W2742  
30" WIDE : W3042  
33" WIDE : W3342  
36" WIDE : W3642

## BRIDGE

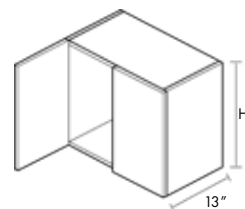

standard depth of 13"

12" HIGH  
30" WIDE : W3012  
33" WIDE : W3312  
36" WIDE : W3612

15" HIGH  
30" WIDE : W3015  
33" WIDE : W3315  
36" WIDE : W3615

18" HIGH  
30" WIDE : W3018  
33" WIDE : W3318  
36" WIDE : W3618

24" HIGH INCLUDES 1 SHELF  
30" WIDE : W3024  
33" WIDE : W3324  
36" WIDE : W3624

## UPLIFT

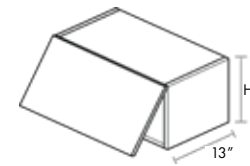

standard depth of 13"

12" HIGH  
30" WIDE : W3012UP  
33" WIDE : W3312UP  
36" WIDE : W3612UP

15" HIGH  
30" WIDE : W3015UP  
33" WIDE : W3315UP  
36" WIDE : W3615UP

18" HIGH  
30" WIDE : W3018UP  
33" WIDE : W3318UP  
36" WIDE : W3618UP

24" HIGH INCLUDES 1 SHELF  
30" WIDE : W3024UP  
33" WIDE : W3324UP  
36" WIDE : W3624UP

## BIFOLD

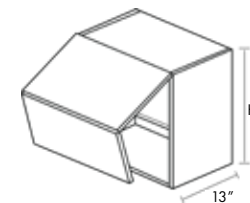

standard depth of 13"

30" HIGH INCLUDES 1 SHELF  
30" WIDE : W3030UP  
36" WIDE : W3630UP

36" HIGH INCLUDES 1 SHELF  
30" WIDE : W3036UP  
36" WIDE : W3636UP

## BLIND CORNER

### RIGHT

standard depth of 13"

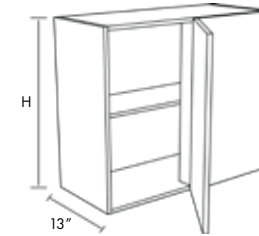

30" HIGH INCLUDES 2 SHELVES  
30" WIDE : WBC3030.R  
  
36" HIGH INCLUDES 2 SHELVES  
30" WIDE : WBC3036.R  
  
42" HIGH INCLUDES 3 SHELVES  
30" WIDE : WBC3042.R

### LEFT

standard depth of 13"



30" HIGH INCLUDES 2 SHELVES  
30" WIDE : WBC3030.L  
  
36" HIGH INCLUDES 2 SHELVES  
30" WIDE : WBC3036.L  
  
42" HIGH INCLUDES 3 SHELVES  
30" WIDE : WBC3042.R

## CORNER

### RIGHT

standard depth of 13"

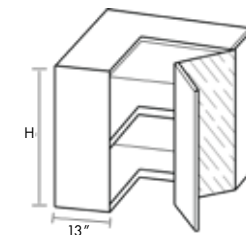

30" HIGH INCLUDES 2 SHELVES  
24" WIDE : WEZR2430.R  
  
36" HIGH INCLUDES 2 SHELVES  
24" WIDE : WEZR2436.R  
  
42" HIGH INCLUDES 3 SHELVES  
24" WIDE : WEZR2442.R

### LEFT

standard depth of 13"

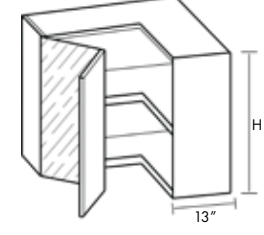

30" HIGH INCLUDES 2 SHELVES  
24" WIDE : WEZR2430.L  
  
36" HIGH INCLUDES 2 SHELVES  
24" WIDE : WEZR2436.L  
  
42" HIGH INCLUDES 3 SHELVES  
24" WIDE : WBC2442.L

## DEEP UPLIFT

standard depth of 24"

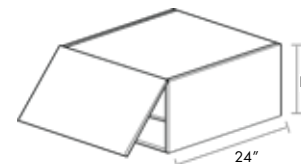

12" HIGH  
36" WIDE : W361224UP  
  
18" HIGH  
36" WIDE : W361824UP  
  
24" HIGH INCLUDES 1 SHELF  
36" WIDE : W362424UP

## DEEP

standard depth of 24"

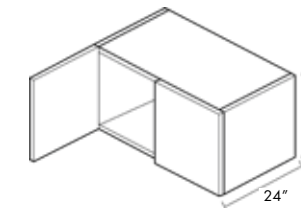

12" HIGH  
36" WIDE : W361224  
  
18" HIGH  
36" WIDE : W361824



# BASE CABINETS

## 1 DOOR

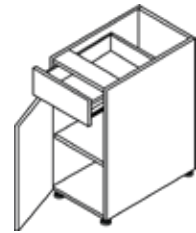

24" deep

34 ½" HIGH INCLUDES 1 SHELF

9" WIDE : IDB09  
12" WIDE : IDB12  
15" WIDE : IDB15  
18" WIDE : IDB18  
21" WIDE : IDB21  
24" WIDE : IDB24

## 2 DOOR

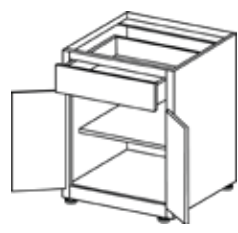

24" deep

34 ½" HIGH INCLUDES 1 SHELF

24" WIDE : IDB24-2  
27" WIDE : IDB27-2  
30" WIDE : IDB30-2  
33" WIDE : IDB33-2  
36" WIDE : IDB36-2

## FULL HEIGHT

### 1 DOOR

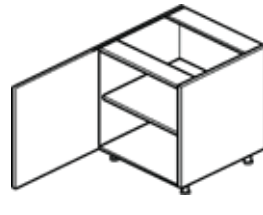

24" deep

34 ½" HIGH INCLUDES 1 SHELF

9" WIDE : BFH09  
12" WIDE : BFH12  
15" WIDE : BFH15  
18" WIDE : BFH18  
21" WIDE : BFH21  
24" WIDE : BFH24

### 2 DOOR

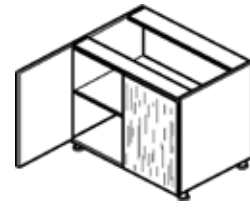

24" deep

34 ½" HIGH INCLUDES 1 SHELF

24" WIDE : BFH24-2  
27" WIDE : BFH27-2  
30" WIDE : BFH30-2  
33" WIDE : BFH33-2  
36" WIDE : BFH36-2

## 2 DRAWER

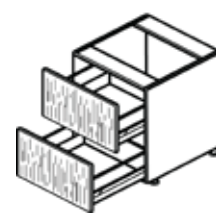

24" deep

34 ½" HIGH

30" WIDE : 2DB30  
33" WIDE : 2DB33  
36" WIDE : 2DB36

## 3 DRAWER

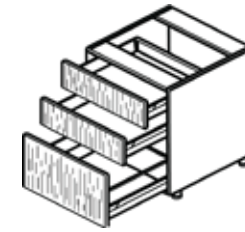

24" deep

34 ½" HIGH

12" WIDE : 3BD12  
15" WIDE : 3BD15  
18" WIDE : 3BD18  
21" WIDE : 3BD21  
24" WIDE : 3BD24  
30" WIDE : 3BD30  
33" WIDE : 3BD33  
36" WIDE : 3BD36

## SINK BASE FULL HEIGHT

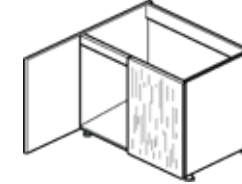

24" deep

34 ½" HIGH

30" WIDE : SB30  
33" WIDE : SB33  
36" WIDE : SB36

FARM SINK

36" WIDE : FS36

## 1 DRAWER 2 DOOR

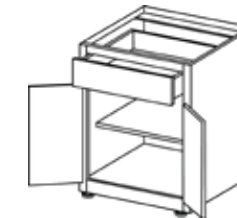

24" deep

34 ½" HIGH

30" WIDE : 1DSB30  
33" WIDE : 1DSB33  
36" WIDE : 1DSB36

## MIRCO BASE

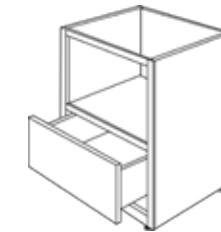

24" deep

34 ½" HIGH

30" WIDE : BMO30

## BASE OVEN

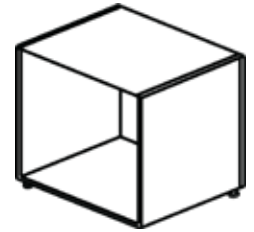

24" deep

34 ½" HIGH

30" WIDE : BO30

## BLIND CORNER

### RIGHT



24" deep

34 ½" HIGH

42" WIDE : BLB42.R  
45" WIDE : BLB45.R

### LEFT



24" deep

34 ½" HIGH

42" WIDE : BLB42.L  
45" WIDE : BLB45.L

## CORNER

### RIGHT



24" deep

34 ½" HIGH

33" WIDE : CB33.R  
36" WIDE : CB36.R

### LEFT



24" deep

34 ½" HIGH

33" WIDE : CB33.L  
36" WIDE : CB36.L





# TALL CABINETS

## 1 DOOR

### RIGHT

24" deep

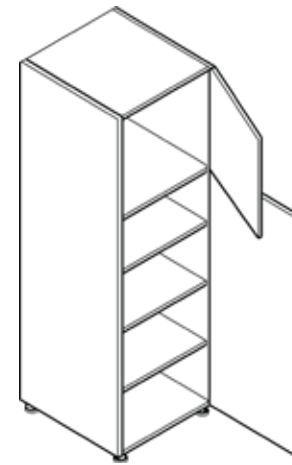

15" WIDE X 24" DEEP INCLUDES 3  
ADJUSTABLE SHELVES + 1 FIXED SHELF

84" HIGH : TP158424.R  
90" HIGH : TP159024.R  
96" HIGH : TP159624.R

18" WIDE X 24" DEEP INCLUDES 3  
SHELVES + 1 FIXED SHELF

84" HIGH : TP188424.R  
90" HIGH : TP189024.R  
96" HIGH : TP189624.R

24" WIDE X 24" DEEP INCLUDES 3  
SHELVES + 1 FIXED SHELF

84" HIGH : TP248424.R  
90" HIGH : TP249024.R  
96" HIGH : TP249624.R

### LEFT

24" deep

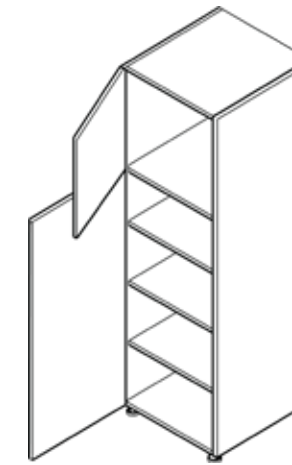

15" WIDE X 24" DEEP INCLUDES 3  
ADJUSTABLE SHELVES + 1 FIXED SHELF

84" HIGH : TP158424.L  
90" HIGH : TP159024.L  
96" HIGH : TP159624.L

18" WIDE X 24" DEEP INCLUDES 3  
SHELVES + 1 FIXED SHELF

84" HIGH : TP188424.L  
90" HIGH : TP189024.L  
96" HIGH : TP189624.L

24" WIDE X 24" DEEP INCLUDES 3  
SHELVES + 1 FIXED SHELF

84" HIGH : TP248424.L  
90" HIGH : TP249024.L  
96" HIGH : TP249624.L

## 2 DOOR

24" deep - 3 adjustable shelves + 1 fixed shelf

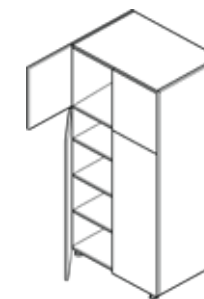

24" WIDE X 24" DEEP

84" HIGH : TP248424  
90" HIGH : TP249024  
96" HIGH : TP249624

30" WIDE X 24" DEEP

84" HIGH : TP308424  
90" HIGH : TP309024  
96" HIGH : TP309624

## DOUBLE OVEN

24" deep

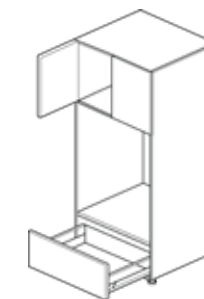

30" WIDE X 24" DEEP

84" HIGH : OC308424  
90" HIGH : OC309024  
96" HIGH : OC309624





# VANITY CABINETS

## FLOATING SINK BASE

21" deep

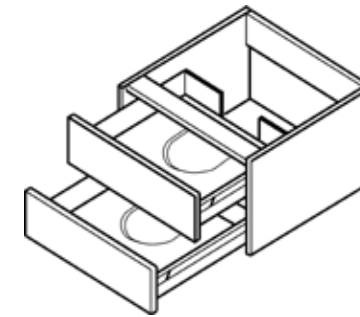

20" HIGH

24" WIDE : VHDSB24

30" WIDE : VHDSB30

36" WIDE : VHDSB36

## FLOATING BASE

21" deep

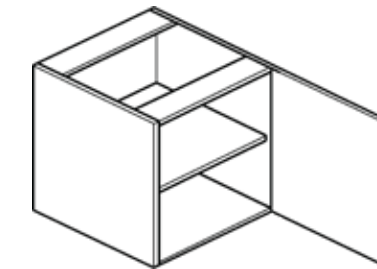

20" HIGH

12" WIDE : VHB12

15" WIDE : VHB15

18" WIDE : VHB18

## 2 DOOR FULL HEIGHT SINK BASE

21" deep

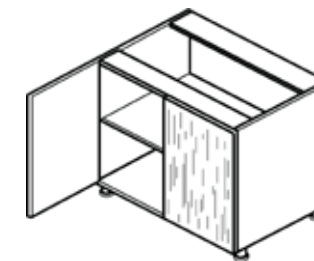

31 1/2" HIGH

24" WIDE : VSB24

30" WIDE : VSB30

36" WIDE : VSB36

## 3 DRAWER BASE

21" deep

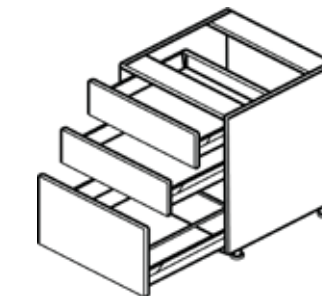

31 1/2" HIGH

12" WIDE : VDB12

15" WIDE : VDB15

18" WIDE : VDB18



# GOLA WALL

## 1 DOOR

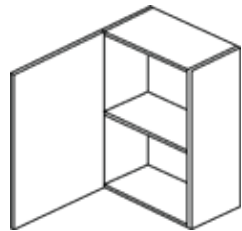

standard depth of 13"

30" HIGH INCLUDES 2 SHELVES

9" WIDE : W0930G  
12" WIDE : W1230G  
15" WIDE : W1530G  
18" WIDE : W1830G  
21" WIDE : W2130G  
24" WIDE : W2430G

36" HIGH INCLUDES 2 SHELVES

9" WIDE : W0936G  
12" WIDE : W1236G  
15" WIDE : W1536G  
18" WIDE : W1836G  
21" WIDE : W2136G  
24" WIDE : W2436G

42" HIGH INCLUDES 3 SHELVES

9" WIDE : W0942G  
12" WIDE : W1242G  
15" WIDE : W1542G  
18" WIDE : W1842G  
21" WIDE : W2142G  
24" WIDE : W2442G

## 2 DOOR

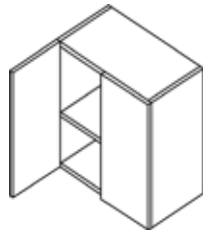

standard depth of 13"

30" HIGH INCLUDES 2 SHELVES

24" WIDE : W2430-2G  
27" WIDE : W2730G  
30" WIDE : W3030G  
33" WIDE : W3330G  
36" WIDE : W3630G

36" HIGH INCLUDES 2 SHELVES

24" WIDE : W2436-2G  
27" WIDE : W2736G  
30" WIDE : W3036G  
33" WIDE : W3336G  
36" WIDE : W3636G

42" HIGH INCLUDES 3 SHELVES

24" WIDE : W2442-2G  
27" WIDE : W2742G  
30" WIDE : W3042G  
33" WIDE : W3342G  
36" WIDE : W3642G

## BLIND CORNER



right

30" HIGH INCLUDES 2 SHELVES

30" WIDE : WBC3030.RG

36" HIGH INCLUDES 2 SHELVES

30" WIDE : WBC3036.RG

42" HIGH INCLUDES 3 SHELVES

30" WIDE : WBC3042.RG

left

30" HIGH INCLUDES 1 SHELF

30" WIDE : WBC3030.LG

36" HIGH INCLUDES 2 SHELVES

30" WIDE : WBC3036.LG

42" HIGH INCLUDES 3 SHELVES

30" WIDE : VWBC3042.LG

## UPLIFT

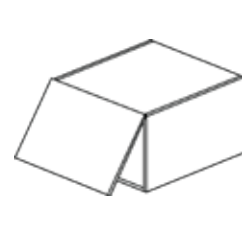

standard depth of 13"

15" HIGH

30" WIDE : W3015UPG  
33" WIDE : W3315UPG  
36" WIDE : W3615UPG

18" HIGH

30" WIDE : W3018UPG  
33" WIDE : W3318UPG  
36" WIDE : W3618UPG

24" HIGH INCLUDES 1 SHELF

30" WIDE : W3024UPG  
33" WIDE : W3324UPG  
36" WIDE : W3624UPG

## BIFOLD

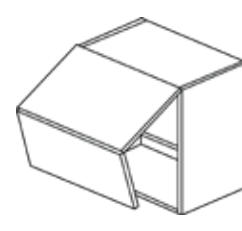

standard depth of 13"

30" HIGH INCLUDES 1 SHELF

30" WIDE : W3030UPG  
36" WIDE : W3630UPG

36" HIGH INCLUDES 2 SHELVES

30" WIDE : W3036UPG  
36" WIDE : W3636UPG







# GOLA BASE

## 1 DOOR

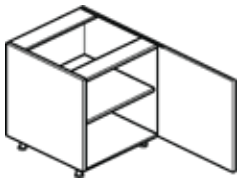

24" deep  
right

34 1/2" HIGH INCLUDES 1 SHELF

9" WIDE : BFH09G.R  
12" WIDE : BFH12G.R  
15" WIDE : BFH15G.R  
18" WIDE : BFH18G.R  
21" WIDE : BFH21G.R  
24" WIDE : BFH24G.R

left

34 1/2" HIGH

9" WIDE : BFH09G.L  
12" WIDE : BFH12G.L  
15" WIDE : BFH15G.L  
18" WIDE : BFH18G.L  
21" WIDE : BFH21G.L  
24" WIDE : BFH24G.L

## 2 DOOR

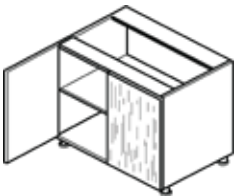

24" deep

34 1/2" HIGH

24" WIDE : BFH24G-2  
27" WIDE : BFH27G  
30" WIDE : BFH30G  
33" WIDE : BFH33G  
36" WIDE : BFH36G

## SINK BASE FULL HEIGHT

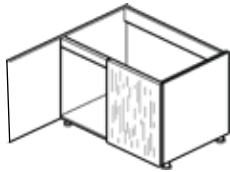

24" deep

34 1/2" HIGH

30" WIDE : SB30G  
33" WIDE : SB33G  
36" WIDE : SB36G

## 2 DRAWER

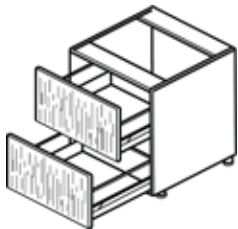

24" deep

34 1/2" HIGH

30" WIDE : 2DB30G  
33" WIDE : 2DB33G  
36" WIDE : 2DB36G

## 3 DRAWER

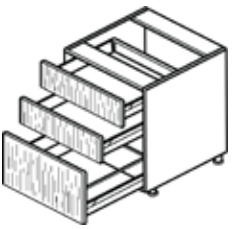

24" deep

34 1/2" HIGH

12" WIDE : 3DB12G  
15" WIDE : 3DB15G  
18" WIDE : 3DB18G  
21" WIDE : 3DB21G  
24" WIDE : 3DB24G  
30" WIDE : 3DB30G  
33" WIDE : 3DB33G  
36" WIDE : 3DB36G

## BLIND CORNER

### RIGHT



24" deep

34 1/2" HIGH

42" WIDE : BLB42G.R  
45" WIDE : BLB45G.R

### LEFT



24" deep

34 1/2" HIGH

42" WIDE : BLB42G.L  
45" WIDE : BLB45G.L



# GOLA TALL

## 1 DOOR LEFT

24" deep - 3 adjustable shelves + 1 fixed shelf

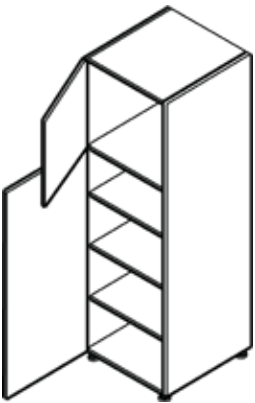

15" WIDE

84" HIGH : TP158424G  
90" HIGH : TP159024G  
96" HIGH : TP159624G

18" WIDE

84" HIGH : TP188424G  
90" HIGH : TP189024G  
96" HIGH : TP189624G

24" WIDE

84" HIGH : TP248424G  
90" HIGH : TP249024G  
96" HIGH : TP249624G

## 1 DOOR RIGHT

24" deep - 3 adjustable shelves + 1 fixed shelf

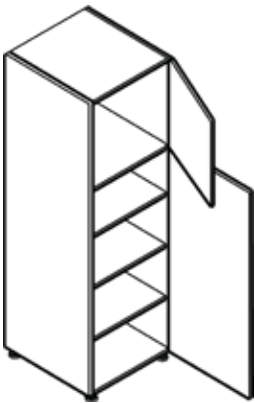

15" WIDE

84" HIGH : TP158424G  
90" HIGH : TP159024G  
96" HIGH : TP159624G

18" WIDE

84" HIGH : TP188424G  
90" HIGH : TP189024G  
96" HIGH : TP189624G

24" WIDE

84" HIGH : TP248424G  
90" HIGH : TP249024G  
96" HIGH : TP249624G







# PANELS & EMBELLISHMENTS

## FILLERS\*



*maholia linen back fillers included*

### TALL

$\frac{3}{4}$ "T x 3" W x 96"L : 901396  
 $\frac{3}{4}$ "T x 6" W x 96"L : 901696

### WALL

$\frac{3}{4}$ "T x 3"W x 30"L : 901330  
 $\frac{3}{4}$ "T x 3"W x 36"L : 901336  
 $\frac{3}{4}$ "T x 3"W x 42"L : 901342

### BASE

$\frac{3}{4}$ "T x 3"W x 30"L : 901330

### VANITY

$\frac{3}{4}$ "T x 3"W x 27"L : 901327

## END PANELS\*



*flat panel door*

### WALL

$\frac{3}{4}$ "T x 14"W x 30"L : 900733  
 $\frac{3}{4}$ "T x 14"W x 36"L : 900739  
 $\frac{3}{4}$ "T x 14"W x 42"L : 900745

### BASE

$\frac{3}{4}$ "T x 25  $\frac{1}{2}$ "W x 34  $\frac{1}{2}$ "L : 900736

### VANITY BASE

$\frac{3}{4}$ "T x 22"W x 31  $\frac{1}{2}$ "L : 900732

### VANITY FLOATING

$\frac{3}{4}$ "T x 22"W x 20"L : 900720

### TALL

$\frac{3}{4}$ "T x 25  $\frac{1}{2}$ "W x 84"L : 900784  
 $\frac{3}{4}$ "T x 25  $\frac{1}{2}$ "W x 90"L : 900790  
 $\frac{3}{4}$ "T x 25  $\frac{1}{2}$ "W x 96"L : 900796

## MITRED RETURN\*



### TALL

1  $\frac{1}{2}$ "RETURN x 25  $\frac{1}{2}$ "W x 84"L : 902784  
1  $\frac{1}{2}$ "RETURN x 25  $\frac{1}{2}$ "W x 90"L : 902790  
1  $\frac{1}{2}$ "RETURN x 25  $\frac{1}{2}$ "W x 96"L : 902796

### BASE END

1  $\frac{1}{2}$ "RETURN x 25  $\frac{1}{2}$ "W x 34  $\frac{1}{2}$ "L : 902736

## CROWN\*

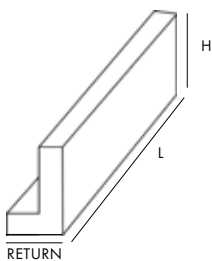

*crowns will be 96" - 120" based on matching material*

### FLAT CROWN

3"RETURN x 3"H x 96"L : 903396  
3"RETURN x 6"H x 96"L : 903696

## MATCHING TOEKICKS\*

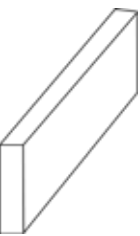

*toekicks will be 96" - 120" based on matching material*

### 34 $\frac{1}{2}$ " HIGH

$\frac{3}{4}$ "T x 4 $\frac{1}{2}$ "H x 96"L : 900596

\* VERTICAL GRAIN TOEKICKS RUN THE WIDTH OF THE BOARD MATERIAL.



# MODERN SOLUTIONS

Modern style efficiently made. We have found solutions to common modern trends made in the same great materials as our other boxes. Bussolotti uses market leading hardware for the Uplift and Bifold Mechanisms, to provide equal performance to the beauty of the cabinets. You can have luxury and efficiency.

FLOATING VANITY



BIFOLD DOORS



UPLIFT DOOR







# SALICE ORGANIZERS



## ROLLOUTS\*

15" WIDE : QCCTAM120M  
18" WIDE : QCCTAM150M  
21" WIDE : QCCTAM180M  
24" WIDE : QCCTAM210M



## BASE PULLOUTS\*

CENTER

12" WIDE : QEGTAM12B20M  
15" WIDE : QEGTAM15B20M  
18" WIDE : QEGTAM18B20M

RIGHT

4 1/4" WIDE 3 SHELF : QELQAM4DXOM  
5 3/4" WIDE 2 SHELF : QELQAM6DXOM

LEFT

4 1/4" WIDE 3 SHELF : QELQAM4SXOM  
5 3/4" WIDE 2 SHELF : QELQAM6SXOM



## WASTE PULLOUTS\*

15" WIDE : QPAM12135CR  
18" WIDE : QPAM15228CR  
21" WIDE : QPAM18228CR  
24" WIDE : QPAM21235CR  
UNDER THE SINK DOUBLE BINS WITH LIDS :  
QPETAM332MC



## BASE BLINDS\*

FLY MOON RIGHT

14" DOOR OPENING : QFLYKITR14  
16" DOOR OPENING : QFLYKITR16  
21" DOOR OPENING : QFLYKITR21

FLY MOON LEFT

14" DOOR OPENING : QFLYKITL14  
16" DOOR OPENING : QFLYKITL16  
21" DOOR OPENING : QFLYKITL21



## BIN ACCESSORIES

CLIP ON

3.2QT : QPAM03C  
5.3QT : QPAM05C

WASTE REPLACEMENT

32QT DOUBLE BIN : QPAM128C  
35QT SINGLE / 21" DOUBLE BIN : QPAM135C  
32QT BIN LID : QPCOLAMF  
35QT SINGLE / 21" DOUBLE BIN LID : QPCOXLMF  
LID FILTER : QPCSF



## BASE CORNERS\*

33" WIDE CABINET : QCGKIT33  
36" WIDE CABINET : QCGKIT36

\* NEED TO SPECIFY OPTIONS

**VCH**: CHAMPAGNE WIRE/ MAPLE MELAMINE BASE

**C**: CHROME WIRE/ WHITE MELAMINE BASE



WOODGRAINS

ACCENT

SAVIOLA  
BY SALT

CAYMAN GSDP8	KEY WEST GSDM6	PALISANDRO AZURO GSDF8
ICE GSA80	ROVERE AGENTO GSDH1	EUCALIPTO BROWN GSDH3
EUCALIPTO WHITE GSDH1	MARANELLO GSD1M	MOCA GSP20
BIANCO GSD6R	TEAK SCURO GSDF9	UVA GSP25
CANYON BLEACH GSD23	PALISANDRO WALNUT GSDF6	CARBONE GSDH3
CIMENTO GSDA4	PALISANDRO GRIGIO GSDF9	FUMO GSP32
RIALTO HEMLOCK GSDS8	EUCALIPTIO GREY GSDH2	CANYON COCO GSD19
FANTASIA GSD40R	NOCE RIBERA GSDF2	PECAN SCURO GSDS7
PANNA GSD98R	CANYON WALNUT GSD18	PECAN ROAST GSDR3
LAKESHORE OAK GSDF4	PECAN GOLD GSDS6	CANYON CHARCOAL GSTM2
ROVERE SABBIA GSP01	WILD WOOD GSDP0	LAVA GSDU6
CANYON OAK GSD17	RUSTICA GSDF3	TIGER EYE GSDS2
CORAL SAND GSP42	ROVERE GRIGIO GSDH2	NOTTE GSA54
RUSTIC OAK GSDF5	CORAL BARK GSP46	

SM'ART  
BY SALT

ROCKEFELLER SMW022
EPIC SMW023
OLMO CAFÉ SM4548
OLMO MIELE SM4565
PAMPAS SMW006
CHRYSLER SMW021
TAIGA SMW004
EMPIRE SMW020
BRUCIATO SME005
OLMO FUME SM4521
CENTRAL SMW025
WOOLWORTH SMW026

TERRA  
BY REHAU

CRAFT ELM 4538
WEST HIGHLAND WHITE 0028
NORTHERN OAK 4574
COASTAL OAK 4543
MISSION MAPLE 4520
LAKEFRONT ELM 4539
WHISKEY OAK 4511
VINEYARD OAK 4526
RIVERFRONT ELM 4528
SAW CUT SAND 4526
HARVEST WALNUT 4604
LOFT OAK 4512
DUST PINE 4513
EAST ELM 4548
MOUNTAIN OAK 4512

LEGNO BY  
STEVENSWOOD

WHITE NEBBIA L31
JASPER L34
COASTAL L38
SEROTINA L33
KIRSCHKE L35
NATURAL MARRONE L29
TIMELESS L41
LAUREL L37
EVENING NOTTE L30
ALLARIA L36
MIDNIGHT RUN L39
SEPPIA WALNUT L40

ARTIKA  
BY STEVENSWOOD

PEARL WHITE 043	SHADOW TEAK GT6
MORNING FOG 596	NATURAL TEAK GT7
WHITE ZEBRINE GT85	DRIFT LOUD G92
NATURAL ELM 574	DARK NOCE G90
WEATHERED TEAK GT8	TAKESE TEAK 529
NATURAL RUSTIK G88	GRIGIO NOTTE G86
GRIGIO PINE W29	DAHAT TEAK W64
GREY ECHO 589	MIDNIGHT ECHO 533
CANNELLA RUSTIK G87	BLACK 174
RICHMOND CHERRY W51	
ARIZONA CYPRESS W53	
CARMELO MIST G91	
CARAMEL CHERRY GT9	
DARK ELM 576	

RAIN BY  
STEVENSWOOD

PEARL WHITE 043
BLACK 174

METALICA  
BY SALT

ROSE GOLD PA17CC
SILVER PA17BY
TITANIUM PA17BT
WHITE GOLD PA17CB

FERRO  
BY REHAU

AEGEAN ANCHOR 2263L
GILDED ARROW 2265L
EMPIRE SKYLINE 2266L
METRO MOTION 2264L



MATTE

GLOSS

NITRO  
BY SALT

BIANCO WHITE INL01NF
LATTE INL32NF
COMING SOON GRIGIO PERLA
BEIGE SEDONA INL18NF
CAMELLO INL09NF
GRIGIO NUVOLE INL12NF
CAPPUCCINO INL08NF
COMING SOON VERDE ERBA
MARINE AZURO INL04NF
ANTHRACITE INANTNF
NERO INL07NF

FENIX

BIANCO KOS FX003Z
GRIGIO EFESO FX072S
BEIGE ARIZONA FX074B
CASTORO OTTAWA FX0717
GRIGIO ANTRIM FX0752
GRIGIO LONDRA FX0718
GRIGIO BROMO FX0724
VERDE COMODORO FX0750
BLU FES FX0754
NERO INGO FX0720

NOIR  
BY REHAU

MALTESE MIST 154704
HIGH LOW 154707
CASA BLANCA 154705
CAPITAL STARLIT 154706
BOXCAR BLONDE 154714
SILVER LAKE 154709
SMOKE STACK 154710
TRENCH COAT 154711
GASLIT ALLEY 154712
OLIVE DETOUR 154715
MIDNIGHT DASH 154713
AFTER DARK 154708

SHADE  
BY REHAU

WHITE 154419
LIGHT GREY 154420
STONE GREY 154422
DARK GREY 154421
BLACK 154418

CRYSTAL MATTE  
BY REHAU

BIANCO 1696LMT
NEBBIA 1911LMT
PERLA 1697LMT
SABBIA 1703LMT
FUMO 1702LMT

MEISTER MATT  
BY MERINO

INTERIOR WHITE 21341
FOLKSTONE GREY 25019
GOthic GREY 22059
SLATE 22099
PIANO BLACK 25066

MEISTER GLOSS  
BY MERINO

SOLAR WHITE 25391
FROSTY WHITE 21091
FOLKSTONE GREY 25019
GOthic GREY 22059
SLATE 22099

INNOLAC  
BY SALT\*

BIANCO INL01HG
ANTHRACITE INANTHG
BLACK INBLKHG
EUCALIPTO GREY INDB2HG
ASH INASHHG
PALISANDRO AZURO INDF8HG
CANYON CHARCOAL INTM2HG
CARBONE INDH3HG
ROVERE GRIGIO INDH2HG
EUCALIPTO BROWN INDB3HG
ZEBRANO INDEMHG

CRYSTAL GLOSS  
BY REHAU\*

BIANCO V277B
ZUCCHERO 1923L
PERLA V2892
NEBBIA 1910L
SABBIA 1687L
MENTA 1684L
FUMO 1618L
PIANO 2015L
MARMO BIANCO 1970L
LEGNO SBIANCATO 1976L
MARMO NERO 1971L
MIRROR 1721L

BRILLIANT  
BY REHAU

BIANCO 5000B
MERINGA 5026B
CEMENTO 1919L
GABBIANO 6339B
BIGIO 6340B
MAGNOLIA 5335B
CUBANITE 5338B
CAPPUCCINO 1917L
ROCCIA 2101L
TITANIO 2283L
GRAFITE 2100L
PRUGNA 5642B
MORO 5112B

\* AVAILABLE ONLY AS SLAB DOORS







BUSSOLOTTI AVAILABLE THROUGH PETERMAN LUMBER

**CA** CORPORATE OFFICE:  
10330 ELM AVE.  
FONTANA, CA 92337  
FAX: 909.829.7804  
**909.357.7730**

**AZ** 4110 W. WASHINGTON ST.,  
SUITE 200,  
PHOENIX, AZ 85009  
FAX: 623.936.5214  
**623.936.2627**

**NV** 5625 ARVILLE ST.,  
SUITES C-D,  
LAS VEGAS, NV 89118  
FAX: 702.430.3440  
**702.430.3433**

 **PETERMAN**  
- LUMBER INC. -  
**WWW.PETERMANLUMBER.COM**